

20
25

Product Collection

GENSTAR LIGHTING

HEAD OFFICE ADDRESS :
Commerce Square Office Park, 39 Rivonia Road
Cnr Mellville & Helling Road, Sandhurst

TEL : 011 321 0198 (Sales)

WAREHOUSE ADDRESS :
Invula Logistic, No 1 Medical Road, Midrand

GENSTAR
LIGHTING

INDEX

DOWNLIGHTS

GEN DL 10

PAGE 07



GEN10DLW



GEN10DLSC



GEN10DLBLK

GEN DL 15

PAGE 08



GEN15DLW



GEN15DLSC



GEN15DLBLK

GEN DL 17

PAGE 08



GEN17DLW



GEN17DLSC



GEN17DLBLK

GEN DL 18

PAGE 09



GEN18DLW



GEN18DLSC

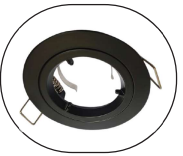

GEN18DLBLK

GEN DL 21

PAGE 09



GEN21DLW



GEN21DLSC

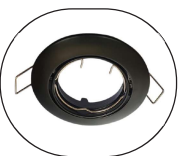

GEN21DLBLK

GEN DL 51

PAGE 10



GEN51DLW



GEN51DLSC

TRACKLIGHTING

PAGE 11



T1TRACK

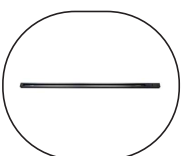

1 M TRACK

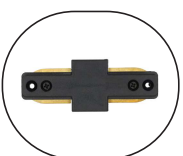

CONNECTOR

INDEX

LAMPS GU10 5.5W

PAGE 12



GEN5.5WGU10NW1 GEN5.5WGU10CW1 GEN5.5WGU10WW1

LAMPS GU10 7W

PAGE 13-14



GEN7WGU10WWND GEN7WGU10CWND GEN7WGU10NWNW GEN7WGU10WW GEN7WGU10CW GEN7WGU10NW GENGU10LH

BULBS 7W & 9W

PAGE 15-16

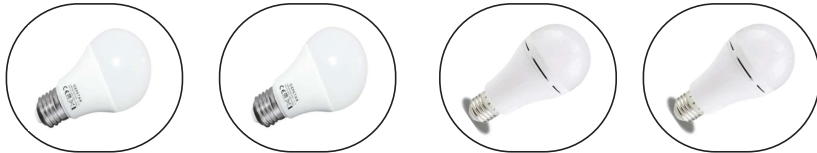

GENA60/9W/E27/NWN GENA60/9W/B22/NWN GENA60/7W/E27EMG GENA70/9W/E27EMG

TUBES

PAGE 17

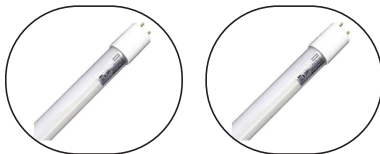

GENT8LED4FT16W GENT8LED5FT22W

BATTENS

PAGE 18



GENBAT2FTLED18W GENBAT4FTLED36W GENBAT5FTLED48W

PANEL LIGHTS

PAGE 19

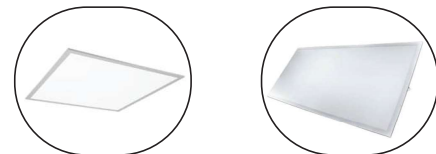

GENPAN6060/40WCCT3/5Y GENPAN60WCCT3/5Y

ROUND PANEL LIGHTS

PAGE 20-21



GENRND GENRNDMSM

INDEX

PORTABLE & RECHARGEABLE - FANS

PAGE 22



GENFAN10W/REG



GENFAN10W/REG/BLK

CEILING FAN LIGHTS

PAGE 23



GENYX20/WH



GENYX20/BLK

CEILING FAN LIGHTS

PAGE 24



GENFS2403SWH



GENS2403RWH

FLOODLIGHTS

PAGE 25-27



GENFLD/10W/NW.5E



GENFLD/20W/NW.5E



GENFLD/30W/NW.5E

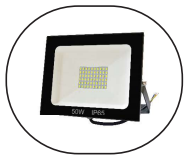

GENFLD/50W/NW.5E



GENFLD/100W/NW.5E

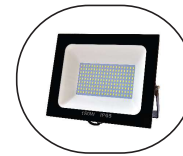

GENFLD/150W/NW.5E



GENFLD/200W/NW.5E



GENFLD/300W/NW.5M



GENFLD/400W/NW.5M



GENFLD/500W/NW.5M



GENFLD/10W/FC



GENFLD/20W/FC



GENFLD/30W/FC



GENFLD/50W/FC

MOTION FLOODLIGHTS

PAGE 27



GENFLD/PIR/20W/NW



GENFLD/PIR/50W/NW

PORTABLE & RECHARGEABLE LIGHTING - FLOODLIGHTS

PAGE 28



GENPORT/100W



GENPORT/200W

INDEX

SOLAR FLOODLIGHTS

PAGE 29-30



GENSOL/30W



GENSOL/60W



GENSOL/150W



GENSOL/50W/N



GENSOL/100W/N



GENSOL/200W/N



GENSOL/300W/N



GENSOL/400W/N



GENSOL/500W/N

SOLAR BOLLARDS

PAGE 31-32



GENSOL/6W/WALL
/PIR/ALU/BLK



GENSOL/6W/BOL
/PIR/ALU/BLK

SOLAR STREETLIGHTS

PAGE 33



GENSOLSTR200WBLK



GENSOLSTR300WBLK



GENSOLSTR400WBLK



GENSOLSTRM

SOLAR POST TOPS

PAGE 34



GENPOST/SOL + 3M POLE

VAPOUR PROOFS

PAGE 35



GENVP4FTLEDS



GENVP5FTLEDS

OPEN CHANNELS

PAGE 36-37

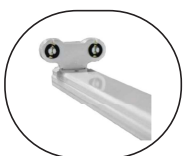

GENOP4FTLEDN

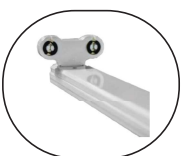

GENOP5FTLEDN

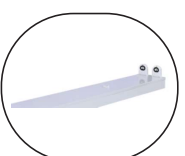

GENOP4FTLEDF

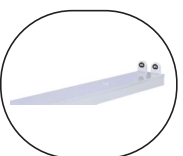

GENOP5FTLEDF



GENHB100W/N



GENHB150W/N



GENHB200W/N

GEN DL DOWNLIGHT SERIES

INTERIOR LIGHTING

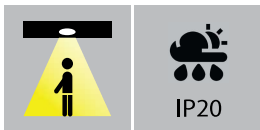
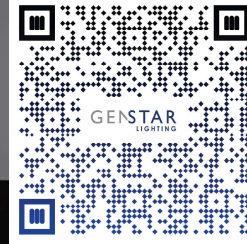

GEN DL 10 DOWNLIGHT SERIES



GEN10DLW



GEN10DLSC



GEN10DLBLK

TECHNICAL PARAMETERS

Main Features

Housing Colour :	White Satin Chrome Black
Housing :	Aluminium, Twist Lock, Tilt
Cut Out :	Ø80MM
Diameter :	Ø95MM
Packaging :	Box Lot 100pcs

GEN DL 15 DOWNLIGHT SERIES



GEN15DLW



GEN15DLSC



GEN15DLBLK

TECHNICAL PARAMETERS

Main Features

Housing Colour :	White Satin Chrome Black
Housing :	Steel Fixed
Cut Out :	Ø55MM
Diameter :	Ø80MM
Packaging :	Box Lot 100pcs

GEN DL 17 DOWNLIGHT SERIES



GEN17DLW



GEN17DLSC



GEN17DLBLK

TECHNICAL PARAMETERS

Main Features

Housing Colour :	White Satin Chrome Black
Housing :	Aluminium, Fixed
Cut Out :	Ø58MM
Diameter :	Ø78MM
Packaging :	Box Lot 100pcs

GEN DL 18 DOWNLIGHT SERIES



GEN18DLW



GEN18DLSC



GEN18DLBLK

TECHNICAL PARAMETERS

Main Features

Housing Colour :	White Satin Chrome Black
Housing :	Aluminium Twist Lock, Fixed
Cut Out :	Ø70MM
Diameter :	Ø81MM
Packaging :	Box Lot 100pcs

GEN DL 21 DOWNLIGHT SERIES



GEN21DLW



GEN21DLSC



GEN21DLBLK

TECHNICAL PARAMETERS

Main Features

Housing Colour :	White Satin Chrome Black
Housing :	Aluminium, Tilt
Cut Out :	Ø74MM
Diameter :	Ø83MM
Packaging :	Box Lot 100pcs

GEN DL 51 DOWNLIGHT SERIES



GEN51DLW



GEN51DLSC

TECHNICAL PARAMETERS

Main Features

Housing Colour :	White Satin Chrome
Housing :	Steel, Tilt
Cut Out :	Ø85MM
Diameter :	Ø100MM
Packaging :	Box Lot 100pcs

GEN T1 TRACKLIGHT

INTERIOR LIGHTING



IP20

GEN T1 TRACKLIGHT SERIES



T1TRACK



1 M TRACK



CONNECTOR

TECHNICAL PARAMETERS

Main Features

Housing :	Aluminium
Housing Colour :	Black
Lamp Base :	GU10 Lamp Holder (Lamp Excluded)
Ingress Protection :	IP20
Spotlight Track Wire :	2 Wire
Track Length :	1 Meter
Track Wire :	3 Wire, 2 Phase Track
Connection :	GEN Connector

GEN GU10 LAMPS

INTERIOR LIGHTING

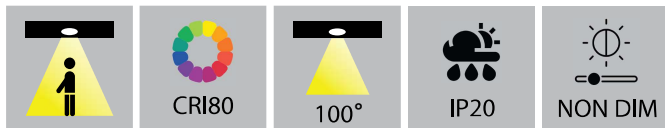

GEN GU10 5.5W LAMPS



GEN5.5WGU10NW1 GEN5.5WGU10CW1 GEN5.5WGU10WW1

TECHNICAL PARAMETERS

Main Features

Power Consumption :	5.5W
Correlated Colour Temperature(CCT) :	3000K 4000K 6500K
Luminous Flux(lm) :	495lm
Beam Angle :	100°
Input Voltage :	240V - 50Hz
Colour Rendering Index :	CRI80
Dimming :	Non Dimmable
Warranty :	2 Year Warranty
Box Lot :	200pcs

GEN GU10 7W ND LAMPS



GEN7WGU10WWND GEN7WGU10CWND GEN7WGU10NWND

TECHNICAL PARAMETERS

Main Features

Power Consumption :	7W
Correlated Colour Temperature(CCT) :	3000K 4000K 6500K
Luminous Flux(lm) :	560lm
Beam Angle :	38°
Input Voltage :	240V - 50Hz
Colour Rendering Index :	CRI80
Dimming :	Non Dimmable
Warranty :	2 Year Warranty
Packaging :	Box Lot 100pcs

GEN GU10 7W LAMPS



GEN7WGU10WW GEN7WGU10CW GEN7WGU10NW

TECHNICAL PARAMETERS

Main Features

Power Consumption :	7W
Correlated Colour Temperature(CCT) :	3000K 4000K 6500K
Luminous Flux(lm) :	600lm
Beam Angle :	38°
Input Voltage :	240V - 50Hz
Colour Rendering Index :	CRI80
Dimming :	Dimmable
Warranty :	2 Year Warranty
Packaging :	Box Lot 100pcs

GEN GU10 LAMP HOLDER



GENGU10LH

TECHNICAL PARAMETERS

Main Features

Input Voltage :	220V-240V
Accessories :	Complete With Bracket
Compliance :	SABS Approved

GEN A60 LAMPS

INTERIOR LIGHTING

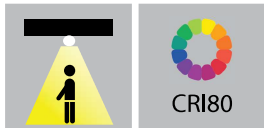

GEN A60 9W LAMPS



GENA60/9W/E27/NWN

GENA60/9W/B22/NWN

TECHNICAL PARAMETERS

Main Features

Power Consumption :	9W
Correlated Colour Temperature(CCT) :	6500K
Luminous Flux(lm) :	810lm
Input Voltage :	240V - 50Hz
Colour Rendering Index :	CR180
Power Factor :	PF >0,7
Lamp Base :	E27 B22
Dimming :	Non Dimmable
Warranty :	2 Year Warranty
Packaging :	Box Lot 100pcs

GEN A60 7W LAMPS



GENA60/7W/E27EMG

TECHNICAL PARAMETERS

Main Features

Power Consumption :	7W
Correlated Colour Temperature(CCT) :	6500K
Luminous Flux(lm) :	560lm
Input Voltage :	240V - 50Hz
Emergency Discharge Time :	±6 Hours
Lamp Base :	E27
Colour Rendering Index :	Non Dimmable
Warranty :	CRI80
Dimming :	Non Dimmable
Warranty :	1 Year Warranty
Packaging :	Box Lot 100pcs

GEN A70 9W LAMPS



GENA70/9W/E27EMG

TECHNICAL PARAMETERS

Main Features

Power Consumption :	9W
Correlated Colour Temperature(CCT) :	6500K
Luminous Flux(lm) :	650lm
Input Voltage :	240V - 50Hz
Emergency Discharge Time :	±6 Hours
Lamp Base :	E27
Colour Rendering Index :	Non Dimmable
Warranty :	CRI80
Dimming :	Non Dimmable
Warranty :	1 Year Warranty
Packaging :	Box Lot 100pcs

GEN T8 TUBES

INTERIOR LIGHTING



GEN T8 4FT & 5FT TUBES



GENT8LED4FT16W

GENT8LED5FT22W

TECHNICAL PARAMETERS

Main Features

Power Consumption :	16W (4FT) 22W (5FT)
Correlated Colour Temperature(CCT) :	6500K
Luminous Flux(lm) :	1600lm (4FT) 2200lm (5FT)
Input Voltage :	240V - 50Hz
Housing :	Single Ended Glass Body
Warranty :	2 Year Warranty
Box Lot :	25pcs

GEN LINEAR BATTEN

INTERIOR LIGHTING



GEN LINEAR BATTEN



GENBAT2FTLED18W GENBAT4FTLED36W GENBAT5FTLED48W

TECHNICAL PARAMETERS

Main Features

Size L*W*H (mm) :	2FT (600*75*25) 4FT (1200*75*25) 5FT (1500*75*25)
Power Consumption :	18W 36W 48W
Luminous Efficacy :	1440lm 2880lm 3850lm
Correlated Colour Temperature(CCT) :	6500K
Housing:	ALUMINIUM + PC LED LINEAR
Power Factor :	PF >0.6
Ingress Protection :	IP20
Warranty :	2 Year
Box lot :	30pcs

GEN BACKLIT PANEL

INTERIOR LIGHTING



IP20

GEN BACKLIT PANEL



GENPAN6060/40WCCT3/5Y



GENPAN60WCCT3/5Y

TECHNICAL PARAMETERS

Main Features

Power Consumption :	40W 60W
Size :	600*600 1200*600
Luminous Efficacy :	120lm/W
Correlated Colour Temperature(CCT) :	3CCT (4000K - 5000K - 6500K)
Driver Type :	Flicker Free Driver
Ingress Protection :	IP20
Warranty :	5 Year
Packaging :	8pcs (600x600) 6pcs (1200x600)

GEN ROUND PANEL LIGHTS

INTERIOR LIGHTING



GEN ROUND RECESSED PANEL



GEN6WRND GEN9WRND GEN12WRND GEN18WRND GEN24WRND

TECHNICAL PARAMETERS

Main Features

Power Consumption :	6W 9W 12W 18W 24W
Luminous Efficacy :	480lm 810lm 1080lm 1620lm 2160lm
Cutout Size (mm) :	φ105 φ125 φ150 φ195 φ270
Product Size (mm) :	Φ90*28 Φ120*28 Φ170*28 Φ220.7*29 Φ296*29
Input Voltage :	AC220V-240V
Correlated Colour Temperature(CCT) :	3CCT (3000K 4000K 6500K)
Power Factor :	>0.5 (6W-12W) >0.9 (18W-24W)
Colour Rendering Index :	Ra80

GEN ROUND SURFACE PANEL



GEN18WRNDSM GEN24WRNDSM

TECHNICAL PARAMETERS

Main Features

Power Consumption :	18W 24W
Luminous Efficacy :	1620lm 2160lm
Product Size (mm) :	Φ217*31 Φ290*31
Input Voltage :	AC220V-240V
Correlated Colour Temperature(CCT) :	3CCT (3000K 4000K 6500K)
Power Factor :	>0.9
Colour Rendering Index :	Ra80

GEN RECHARGEABLE FAN

INTERIOR FAN



GEN FAN



GENFAN10W/REG



GENFAN10W/REG/BLK

TECHNICAL PARAMETERS

Main Features

Power Consumption :	10W - 555 Driver
Battery :	18 650 LITHIUM BATTERY 10000 maH, 7.4V
Charger :	8V1.5A CHARGER 1M - DC5521 PINS
Working Modes :	3 Wind Speed
Blade Count :	5 pcs
Size(mm) :	430*102*1.0
Diameter :	400mm
Weight :	2kg
Packaging :	P1 PC/CTN, 51,5*15,5*43.5 : 6 KG

GEN CEILING FAN

INTERIOR LIGHTING & FAN



GEN CEILING FAN



GENYX20/WH



GENYX20/BLK

TECHNICAL PARAMETERS

Main Features

Power Consumption :	38W (NW/WW) 51W (CW)
Colour Temperature :	NW WW CW Memory Function
Motor :	Low Voltage Copper Motor Speed : 220-240V
Input Voltage :	AC110-265V
Blade Material :	ABS - 80g 4pcs
Accessories :	Remote Control - Optional two directions

GEN CEILING FAN

INTERIOR LIGHTING & FAN



GEN CEILING FAN



GENFS2403SWH



GENS2403RWH

TECHNICAL PARAMETERS

Main Features

Power Consumption (Luminaire) :	80W
Power Consumption (Motor) :	20W
Lumens :	3680lm (Square) 3680lm (Round)
Correlated Colour Temperature(CCT) :	Changeable
Accessories :	Remote Control

GEN LED FLOODLIGHTS

EXTERIOR LIGHTING

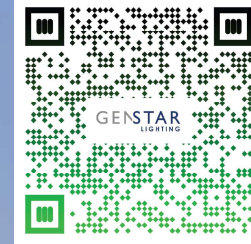

GEN FLOODLIGHTS



GENFLD/10W/NW.5E GENFLD/20W/NW.5E GENFLD/30W/NW.5E

TECHNICAL PARAMETERS

Main Features

Power Consumption :	10W	20W	30W
Luminous Flux(lm) :	800lm	1600lm	2400lm
Correlated Colour Temperature(CCT) :	6500K		
Input Voltage:	220V-240V		
Power Factor :	>0.9		
Ingress Protection :	IP65		
Electrical Class :	Class 1		
Cable Type :	50CM Rubber Cable		
Surge Protection :	2KV		
Chipset Type :	SMD		
Warranty :	2 year Warranty		
Box lot :	50pcs(10W&20W) 40pcs(30W)		

GEN FLOODLIGHTS



GENFLD/50W/NW.5E GENFLD/100W/NW.5E GENFLD/150W/NW.5E

TECHNICAL PARAMETERS

Main Features

Power Consumption :	50W	100W	150W
Luminous Flux(lm) :	4000lm	8000lm	12 000lm
Correlated Colour Temperature(CCT) :	6500K		
Input Voltage:	220V-240V		
Power Factor :	>0.9		
Ingress Protection :	IP65		
Electrical Class :	Class 1		
Cable Type :	50CM Rubber Cable		
Surge Protection :	4KV		
Chipset Type :	SMD		
Warranty :	2 year Warranty		
Box lot :	30pcs (50W) 10pcs (100W & 150W)		

GEN FLOODLIGHTS

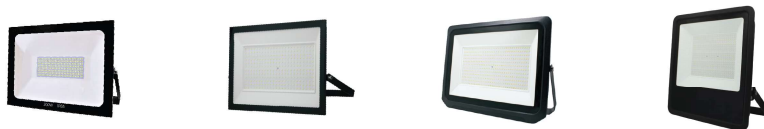

GENFLD/200W/NW.5E GENFLD/300W/NW.5M GENFLD/400W/NW.5M GENFLD/500W/NW.5M

TECHNICAL PARAMETERS

Main Features

Power Consumption :	200W	300W	400W	500W
Luminous Flux(lm) :	16 000lm	24 000lm	32 000lm	40 000lm
Correlated Colour Temperature(CCT) :	6500K			
Input Voltage:	220V-240V			
Power Factor :	>0.9			
Ingress Protection :	IP65			
Electrical Class :	Class 1			
Cable Type :	50CM Rubber Cable			
Surge Protection :	4KV			
Chipset Type :	SMD			
Warranty :	2 year Warranty			
Box lot :	5pcs (200W-300W) 4pcs (400W) 1pc (500W)			

GEN FC FLOODLIGHTS



GENFLD/10W/FC



GENFLD/20W/FC



GENFLD/30W/FC



GENFLD/50W/FC

TECHNICAL PARAMETERS

Main Features

Power Consumption :	10W	20W	30W	50W
Luminous Flux(lm) :	1200lm	2400lm	3600lm	6000lm
Correlated Colour Temperature(CCT) :	6500K			
Input Voltage:	220V-240V			
Power Factor :	>0.9			
Ingress Protection :	IP65			
Electrical Class :	Class 1			
Connector Type :	Fast Connector Cable Input System			
Surge Protection :	1KV (10W&20W) 2KV (30W&50W)			
Beam Angle :	120°			
Warranty :	3 year Warranty			
Box lot :	40pcs (10W) 20pcs (20W/30W/50W)			

GEN PIR FLOODLIGHTS



GENFLD/PIR/20W/NW



GENFLD/PIR/50W/NW

TECHNICAL PARAMETERS

Main Features

Power Consumption :	20W	50W
Luminous Flux(lm) :	1600lm	4000lm
Correlated Colour Temperature(CCT) :	6500K	
Input Voltage:	220V-240V	
Power Factor :	>0.9	
Ingress Protection :	IP44	
Electrical Class :	Class 1	
Product Size :	130*50*154MM(20W) 210*50*203MM(50W)	
Surge Protection :	1.5KV 4KV	
Chipset Type :	SMD	
Warranty :	2 year Warranty	
Packaging :	40pcs (20W) 20pcs (50W)	

GEN PORTABLE FLOODLIGHTS

EXTERIOR LIGHTING

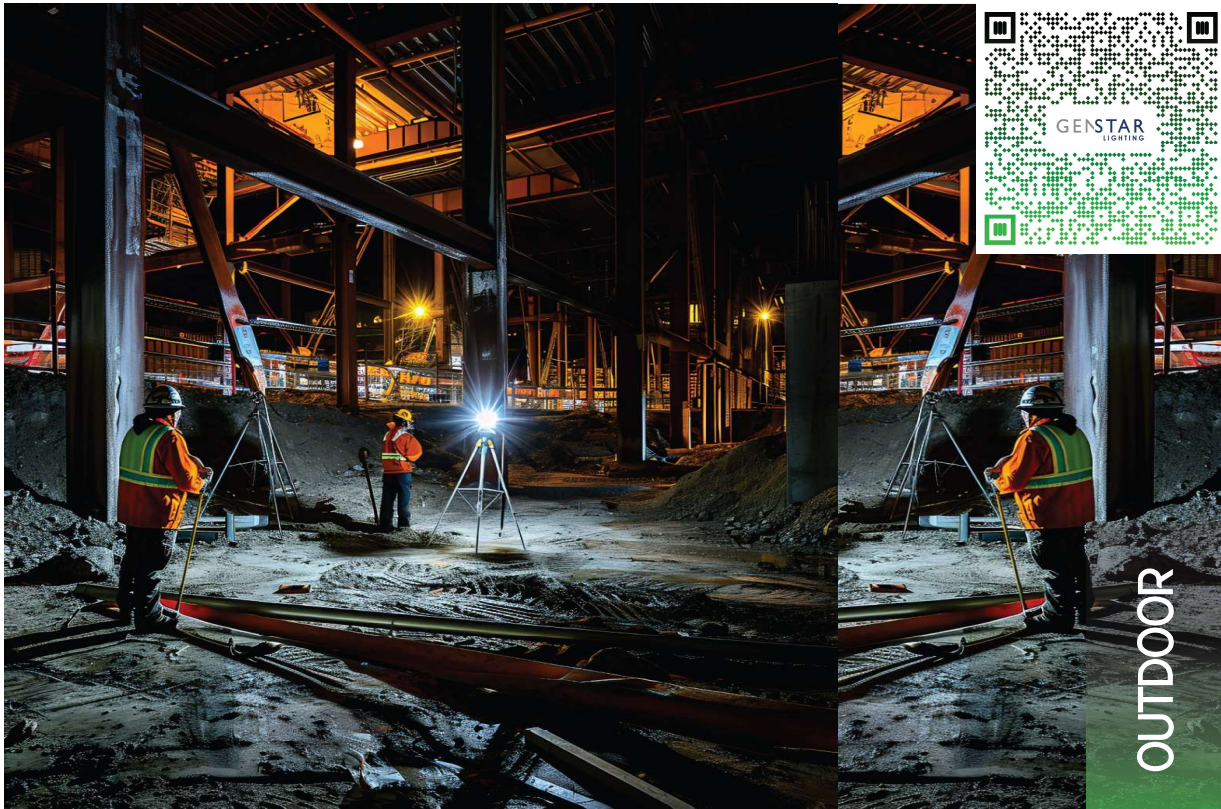

GEN PORTABLE FLOODLIGHTS



GENPORT/100W



GENPORT/200W

TECHNICAL PARAMETERS

Main Features

Power Consumption :	100W 200W
Luminous Flux(lm) :	500lm 800lm
Charging Time :	3-5 Hours
Beam Angle:	90°
Operating Temperature :	-10°C - +45°C
Working Modes :	LEVEL 1 : 1ST GEAR FLASHING WARNING LEVEL 2 : HIGHLIGHT FOR 3 HOURS LEVEL 3 : MEDIUM LIGHT LEVEL 4 : LOW LIGHT FOR 10-15 HOURS LEVEL 5 : 5TH GEAR TURN OFF LIGHT
Warranty :	2 year Warranty
Size :	180*42*217mm(100W) 240*42*245mm(200W)

GEN SOLAR FLOODLIGHTS

EXTERIOR LIGHTING



GEN SOLAR FLOODLIGHTS



GENSOL/30W



GENSOL/60W



GENSOL/150W

TECHNICAL PARAMETERS

Main Features

Power Consumption :	30W 60W 150W
Power Supply :	No Power Supply Required
Correlated Colour Temperature(CCT) :	6500K
Housing:	Aluminium Body + Reflector
Accessories :	Complete with remote, bolts and solar panel
Working Modes :	3/6/8 HR OUTPUT PRESET
Ingress Protection :	IP66
Charging Time :	5-7 Hours
Discharge Time :	20 Hours Working Time
Battery :	Lithium Phosphate Battery
Box lot :	10pcs (30W) 8pcs (60W) 6pcs (150W)

GEN SOLAR FLOODLIGHTS



GENSOL/50W/N



GENSOL/100W/N



GENSOL/200W/N

TECHNICAL PARAMETERS

Main Features

Power Consumption :	50W 100W 200W
Luminous Flux :	520lm 860lm 1300lm
Battery (Lithium Phosphate Battery) :	3.2V 4AH 3.2V 6AH 3.2V 9AH
Solar Panel :	6V/6W 6V/8W 6V/12W
Ingress Protection :	IP66
Correlated Colour Temperature(CCT) :	6500K
Housing :	Aluminium Body + Reflector
Accessories :	Complete with remote, bolts and solar panel
Working Modes :	3/6/9 HR OUTPUT PRESET
Charging Time :	5-6 Hours
Size :	180*42*217mm (50W-100W) 204*42*245mm (200W)
Box lot :	10pcs (50W/100W) 8pcs (200W)

GEN SOLAR FLOODLIGHTS



GENSOL/300W/N



GENSOL/400W/N



GENSOL/500W/N

TECHNICAL PARAMETERS

Main Features

Power Consumption :	300W 400W 500W
Luminous Flux :	1900lm 2400m 3200lm
Battery (Lithium Phosphate Battery) :	3.2V 15AH 3.2V 21AH 3.2V 27AH
Solar Panel :	6V/18W 6V/22W 6V/30W
Ingress Protection :	IP66
Correlated Colour Temperature(CCT) :	6500K
Housing :	Aluminium Body + Reflector
Accessories :	Complete with remote, bolts and solar panel
Working Modes :	3/6/9 HR OUTPUT PRESET
Charging Time :	5-6 Hours
Size :	220*42*270 260*42*306 300*45*348
Box lot :	5pcs (300W) 4pcs (400W/500W)

GEN SOLAR BOLLARD & WALL LIGHT

EXTERIOR LIGHTING

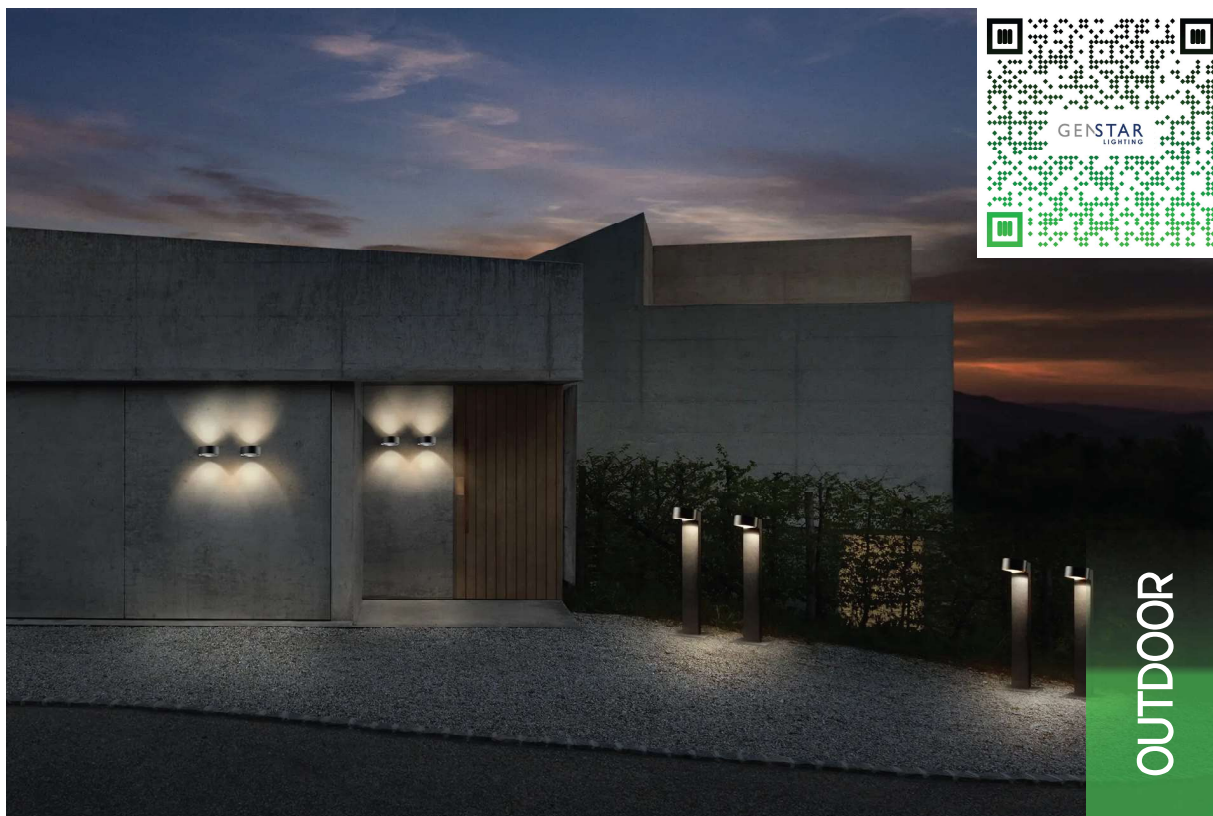

IP54

GEN SOLAR WALL LIGHT



GENSOL/6W/WALL/PIR/ALU/BLK

TECHNICAL PARAMETERS

Main Features

Power Consumption :	6W
Luminous Flux (lm):	900lm - Module 600lm - Whole Product
Housing:	Aluminium - IP54
Battery:	3.7V 3000mAh Li-ion Battery
Solar Panel :	5V/650mA
Working Modes :	Mode 1: 50% brightness@4hrs
	Mode 2: Always on with 20% brightness&glow when sensed 100%X30S
	Mode 3: Glow only sensed with 100% brightness @30SX240 times
	Mode 4: 100% brightness @ 2hrs

Long Push :	turn on/turn off
Short Push :	switch from one mode to the next one with sensor
Sensor range :	100°
Sensor Distance :	up to 8M
Size :	245x126x66mm

GEN SOLAR BOLLARD



GENSOL/6W/BOL/PIR/ALU/BLK

TECHNICAL PARAMETERS

Main Features

Power Consumption :	6W
Luminous Flux (lm):	900lm - Module 600lm - Whole Product
Housing:	Aluminium - IP54
Battery:	3.7V 3000mAh Li-ion Battery
Solar Panel :	5V/650mA
Working Modes :	Mode 1: 50% brightness@4hrs
	Mode 2: Always on with 20% brightness&glow when sensed 100%X30S
	Mode 3: Glow only sensed with 100% brightness @30SX240 times
	Mode 4: 100% brightness @ 2hrs
Long Push :	turn on/turn off
Short Push :	switch from one mode to the next one with sensor
Sensor range :	100°
Sensor Distance :	up to 8M
Size :	299x170x617mm

GEN SOLAR STREETLIGHT

EXTERIOR LIGHTING



GEN SOLAR STREETLIGHT



GENSOLSTR200WBLK



GENSOLSTR300WBLK



GENSOLSTR400WBLK



GENSTRARM

TECHNICAL PARAMETERS

Power Consumption :	200W	300W	400W
Luminous Flux :	530lm	900lm	1200lm
Solar Panel :	6V 9W	6V 12W	6V 12W
32650 Battery :	3.2V - 6000MAH (200W) 3.2V - 10000MAH (300W-400W)		
Accessories :	Complete with remote		
Sensor Features :	PLUS PIR + LIGHT SENSOR		
Ingress Protection :	IP65		
Charging Time :	5-7 Hours		
Discharge Time :	20 Hours Working Time		
Correlated Colour Temperature(CCT) :	6500K - 7000K		
Size :	68*22*42.5CM 76.5*24*52CM 65*43*27.5CM		
Suggested Mounting Height:	3-6 Meters		
Arm Size :	30*30*20CM - 50CM		
Warranty :	1 Year		

GEN SOLAR POST TOP

EXTERIOR LIGHTING



GEN SOLAR POST TOP



GENPOST/SOL + 3M POLE

TECHNICAL PARAMETERS

Main Features

Power Consumption :	500W
Solar Panel :	6V 28W
Battery :	3,2V 20AH - Lithium-ion Battery
Controller :	3,2V 10A
Beam Angle :	360°
Charging Time :	6-8 Hours
Pole Height :	3 Meter High Pole 15-20 Meters Spacing Between
Pole Material :	Iron Pole
Working Mode :	Light control time + remote control
Working Temperature :	-20°C + 65°C
Ingress Protection :	IP65
Lamp Size :	600*600*95mm
Warranty :	2 Year

GEN VAPOUR PROOFS

INDUSTRIAL LIGHTING



GEN VAPOUR PROOFS



GENVP4FTLEDS

GENVP5FTLEDS

TECHNICAL PARAMETERS

Main Features

Size :	4FT (1262*100*76) 5FT (1562*100*76)
Lamp Base :	T8
Input Voltage :	220V-240V
Wiring:	Pre-Wired for LED Tubes
Housing :	ABS Body PC Diffuser
Ingress Protection :	IP65
Clips :	Metal
Warranty :	2 Year
Packaging :	8pcs

GEN OPEN CHANNELS

INDUSTRIAL LIGHTING



GEN OPEN CHANNEL



GENOP4FTLEDN GENOP5FTLEDN

TECHNICAL PARAMETERS

Main Features

Size :	4FT (1230*50*30MM) 5FT (1530*50*30MM)
Lamp Base :	T8
Input Voltage :	220V-240V
Wiring:	Pre-Wired for LED Tubes
Circuit :	Single Ended
Ingress Protection :	IP20
Warranty :	2 Year
Packaging :	20pcs

GEN FLAT BODY OPEN CHANNEL



GENOP4FTLEDF

GENOP5FTLEDF

TECHNICAL PARAMETERS

Main Features

Size :	4FT (1230*80*32mm) 5FT (1530*80*32mm)
Lamp Base :	T8
Input Voltage :	220V-240V
Wiring:	Pre-Wired for LED Tubes
Circuit :	Single Ended
Ingress Protection :	IP20
Warranty :	2 Year
Packaging :	10pcs



GEN HIGH BAYS

INDUSTRIAL LIGHTING



GEN HIGH BAY



GENHB100W/N



GENHB150W/N



GENHB200W/N

TECHNICAL PARAMETERS

Main Features

Power Consumption :	100W 150W 200W
Luminous Efficacy :	10 000lm 15 000lm 30 000lm
Input Voltage :	AC220V-240V
Correlated Colour Temperature(CCT) :	6500K
Surge Protection :	4KV
Ingress Protection :	IP65
Operating Temperature :	-25°C - +45°C
Size :	250*42mm
Colour :	Black
Warranty :	3 Year
Box lot :	20pcs (100W) 10pcs (150W/200W)

CANCELLATION & RETURNS POLICY

Please note that any cancellation of orders or return of goods delivered, will only be accepted with the express, written approval from Genstar Lighting (Pty) Ltd. Kindly follow the guidelines of the policy as laid out here under in order to avoid any possible delays or misconceptions relating to this subject.

1. Any cancellation of a confirmed order (verbal or written), is subject to the acceptance thereof by Genstar Lighting in writing.
2. Should you wish to return goods which have been correctly delivered by Genstar Lighting (Pty) Ltd, a correctly complete "Return for Credit Request" CRC form must be submitted to Genstar Lighting, with a copy of the Original invoice attached.
3. Once the request has been approved and signed by Genstar Lighting, it will be returned to you reflecting an upliftment number. This does not yet guarantee a credit will be passed.
4. Only once you have received the document reflecting the upliftment number, may you proceed to return the goods to the Genstar Lighting warehouse in Midrand.
5. It is your responsibility to arrange for the safe transportation of the returned goods to our stores.
6. It is imperative that the goods are received in an original box with packaging & contents undamaged.
7. On receipt of the goods, they will be checked. If it is found that the returned goods are in a saleable condition, a 15% handling fee will be levied against your account. Please note that over and above the handling fee charged by Genstar Lighting, it may also be possible for an additional fee to be charged by our suppliers. You will be notified of this at the time of return and any such fee will be passed on to you.
8. If it is found that they are not in an immediate saleable condition, you will be notified of the fact. You will then be responsible to collect the goods from our stores within 14 days from date of notification.

THE FOLLOWING REASONS WILL NOT BE CONSIDERED FOR GOODS TO BE RETURNED:

1. Goods returned more than one (1) month after delivery date.
2. Non-stock items, buy outs and specially manufactured products.
3. Any product returned in a non-re-saleable condition i.e.
 - a. Damaged
 - b. Packaging is damaged or has been opened.

This is provided that all claims are made in writing and within 7 days from date of delivery. Kindly note, it is entirely your responsibility to ensure that we have received notification from yourself.

GENSTAR LIGHTING

HEAD OFFICE ADDRESS :

Commerce Square Office Park, 39 Rivonia Road
Cnr Mellville & Helling Road, Sandhurst

TEL : 011 321 0198 (SALES)

WAREHOUSE ADDRESS :

Invula Logistic, No 1 Medical Road, Midrand